

Quick Installation Guide

Wireless-N Broadband Router

Copyrights 2013 by TOTOLINK All rights reserved. Website: <http://www.totolink.net>
Information in this document is subject to change without prior notice.

1 Hardware Installation

If you access Internet by ADSL, please comply with step 1, 2, 3 and 4 in below diagram in correct order; if you access Internet by residential broadband, please comply with step 2, 3 and 4 to connect the WAN port of your router with the residential broadband directly.

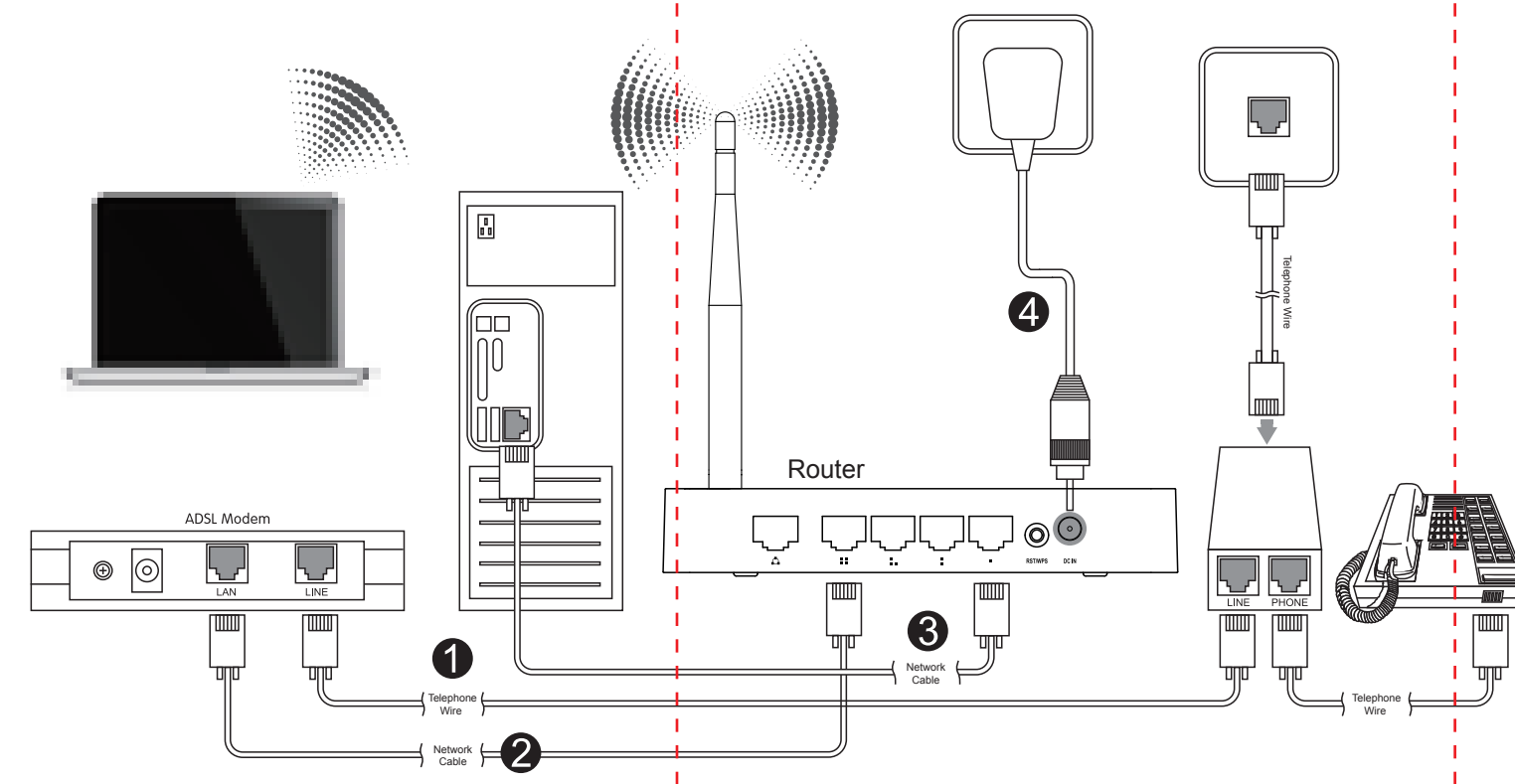

After connected, please check whether the indicator lights are normal.

Name	Normal Status
Power	This indicator lights when the router is powered on, otherwise it is off.
CPU	This indicator keeps lighting when Router powered on.
WLAN	This indicator lights when there are wireless devices connected and transmitting data to WLAN Router.
WAN	When the WAN port is connected successfully the indicator lights. During transmitting or receiving data through the WAN port the indicator blinks.
1/2/3/4 LAN	When one of the LAN ports has a successful connection, the corresponding indicator lights. During transmitting or receiving data through the LAN port the indicator blinks.

NOTE:

1. Please disconnect the power adapter and all cables during thunderstorm weather.
2. Keep away from heat source and keep well ventilated;
3. Please pay attention to the waterproofing and moisture-proof when storing, transporting and running;
4. The power supply must reach the rated current and power;
5. Put the router in flat places.

2 Set Up PC

Windows 2000/XP For Windows 2000 or Windows XP Operating System, please comply with following steps to set up.

1. Right-click "My Network Places", click "Properties"
2. Right-click "Local Area Connection", click "Properties"
3. Double-click "Internet Protocol (TCP/IP)"
4. Choose "Obtain an IP address automatically" and "Obtain DNS server address automatically", click "OK", go back to previous interface and click "OK"

Windows Vista/7 For Windows Vista or Windows 7 Operating System, please comply with following steps to set up.

1. Click "Start—Control Panel—Network and Internet—Network Connection", right-click "Local Area Connection", and choose "Properties"
2. Double-click "Internet Protocol Version 4 (TCP/IPv4)"
3. Choose "Obtain an IP address automatically" and "Obtain DNS server address automatically", click "OK", go back to previous interface and click "OK"

3 Set Up Router

Please set up the router following below steps.

1. Run the Web browser.
2. Type 192.168.1.1 in the Web browser address bar, and then press Enter.
3. It will show up the following page, please click Internet Wizard icon
4. Enter valid User Name and Password (The default user name and password are "admin"). Then click "Log In" button or press Enter.
5. You can choose "Automatic Internet Configuration" or "Manual Internet Configuration" in this page. Suggests to choose "Manual Internet Configuration" if you know the connection type provided by your ISP. Here we take it for example.
6. Choose Internet connection types provided by your ISP.
7. The DHCP method is selected by default. Here we take it as an example. You can choose one method to set MAC address according to need. Then click "Next".
8. Click Save and Close button to reply configuration.
9. After Internet wizard, please click the wireless wizard icon to start wireless settings. Click "Next" to process this wizard.

4 Wireless Network Connection

1. Right-click "My Network Places", click "Properties"
2. Right-click "Wireless Network Connection", and click "View Available Wireless Networks"
3. Confirm the wireless network SSID name, choose one that you would like to connect, then click "Connect"
4. Input the encryption key and click "Connect"
5. Have connected wireless network, you can access internet through wireless mode.
10. Choose your country region and click "Next".
11. You can setup the wireless network name and then click "Check SSID" button to make sure your SSID is available. After SSID check is done, click "Next".
12. Choose the best channel, and click "Next".
13. Click "Next" if the setting is no problem.
14. Setup the encryption for the security of your network.
15. Select TKIP or AES cryptography, and then click "Next".
16. Input the password (more than 8 characters).
17. After confirming the settings, click "Finish" button to apply all configuration values.